

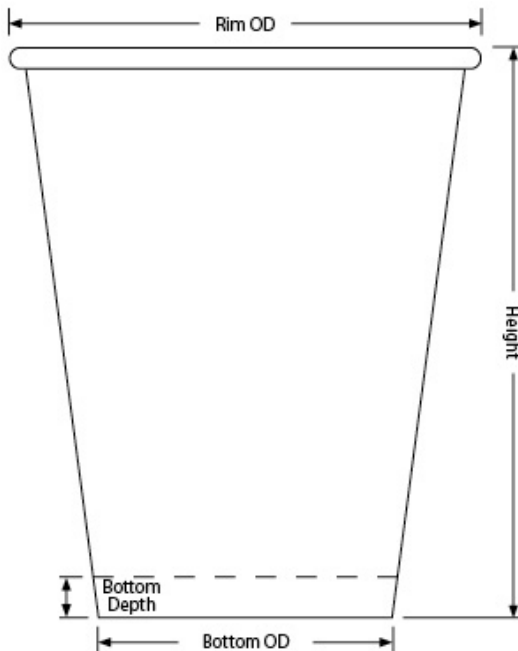

C913 12oz Drink Cup (13)

12oz Recycled Paper COLD Cup



Capacity: 13.10oz / 387.20ml

Material: 16.5pt Recycled Paper, Poly 2-sides, 35% Sustana
EnviroLife Post-Consumer Recycled Fiber, FSC SFI
PEFC Certified

Minimum: 1,000 pieces

Height: 4.248" \pm .015

Rim Height: 0.150" \pm .010

Rim OD: 3.515" \pm .010

Bottom OD: 2.184" \pm .010

Bottom Depth: 0.300" \pm .010

Shipping: FOB NV Made in the USA

12oz Drink Cup (13) available in [Cold Paper](#) [Hot Paper](#)
[Clear Plastic](#) [White Plastic](#)

C913 Standard Case Pack Configuration

Box Dimensions: 18.10"x14.58"x12.01"

Box Volume: 1.83 Cubic Feet

Box Weight: 14 lbs

Box Content: 500 Pieces

Pallet Dimensions: 40.00"x48.00"x89"

Pallet Weight: 633 lbs

Pallet Content: 21,000 Pieces / 42 Boxes

SEE LID OPTIONS ON LAST PAGE

Pallet for C913 (Gloss), M913 (Matte)

12oz Recycled Paper COLD Cup

Pallet View

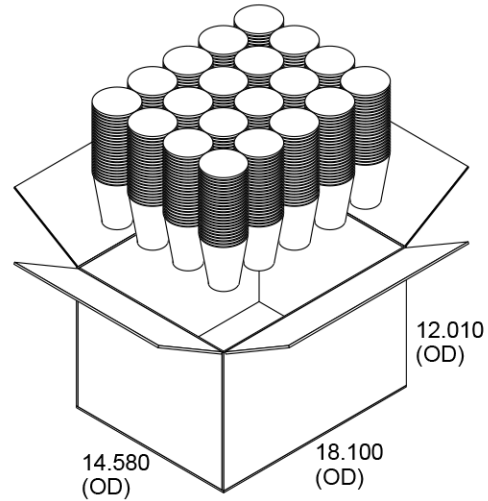
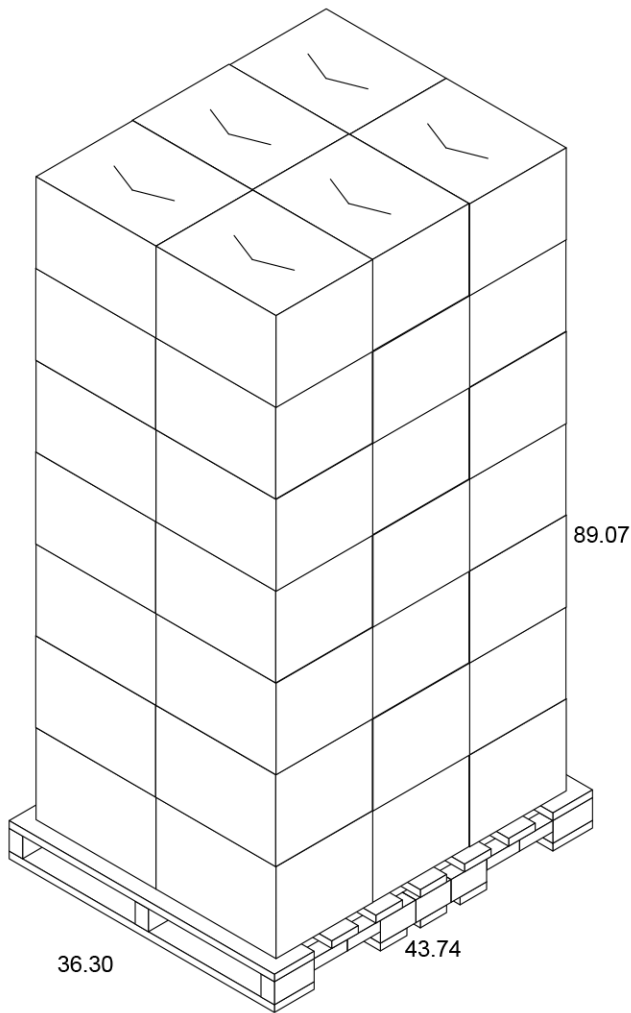

Top View

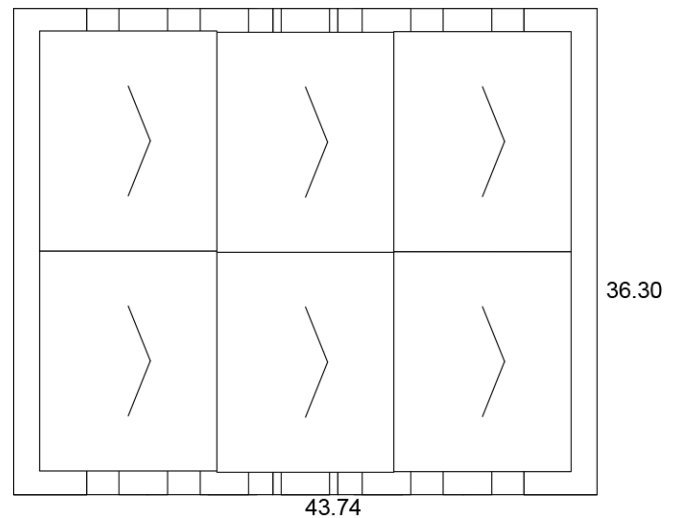

Lid Options for C913 (Gloss), M913 (Matte) 12oz Recycled Paper COLD Cup



P2 Printed Snap-Fit Paper

- Hi-Definition, Full Color
- Customizable
- Seamlessly registered text
- Uninterrupted text
- Three week leadtime
- Case: 500 - 10 lbs



Clear Single-Use Lid

- Clear, thermo-formed
- With & without straw slot
- Case: 1,000 - 8 lbs



Clear High Dome Lid

- Clear, thermo-formed
- With top opening
- Case: 1,000 - 10 lbs



Cappuccino Lid

- White/Black, thermo-formed
- Vented lid
- Case: 1,000 - 8 lbs